

Sound Insulation Index ISO 140-3:1995

Laboratory measurement of airborne sound insulation
 Sponsor: Sauerland Spanplatte

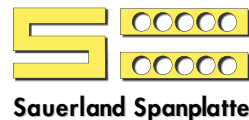

Internal Test

Construction of the test specimen:

- Door leaf 1000 x 2000 x 39,0 mm, sealed
- 1 : Solid particle board 3 x 11 VL, free
- 2 : Hardboard 3 mm
- 3 : Homogeneous Wood VA 35 mm

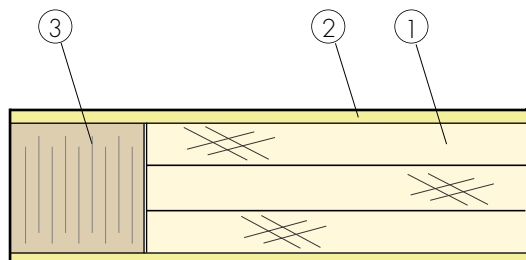

Test opening: 2,00 m²
 Weight of test specimen: 26,0 kg/m²
 Temperature [°C]: 18
 Humidity [%]: 56
 Source room volumes: 72 m³
 Receiver room volumes: 70 m³

frequency [Hz]	R [dB]
50	-.-
63	-.-
80	-.-
100	20.4
125	20.8
160	24.2
200	24.0
250	30.6
315	35.3
400	38.8
500	42.8
630	45.4
800	46.9
1000	48.5
1250	49.7
1600	50.3
2000	44.4
2500	40.2
3150	40.4
4000	-.-
5000	-.-

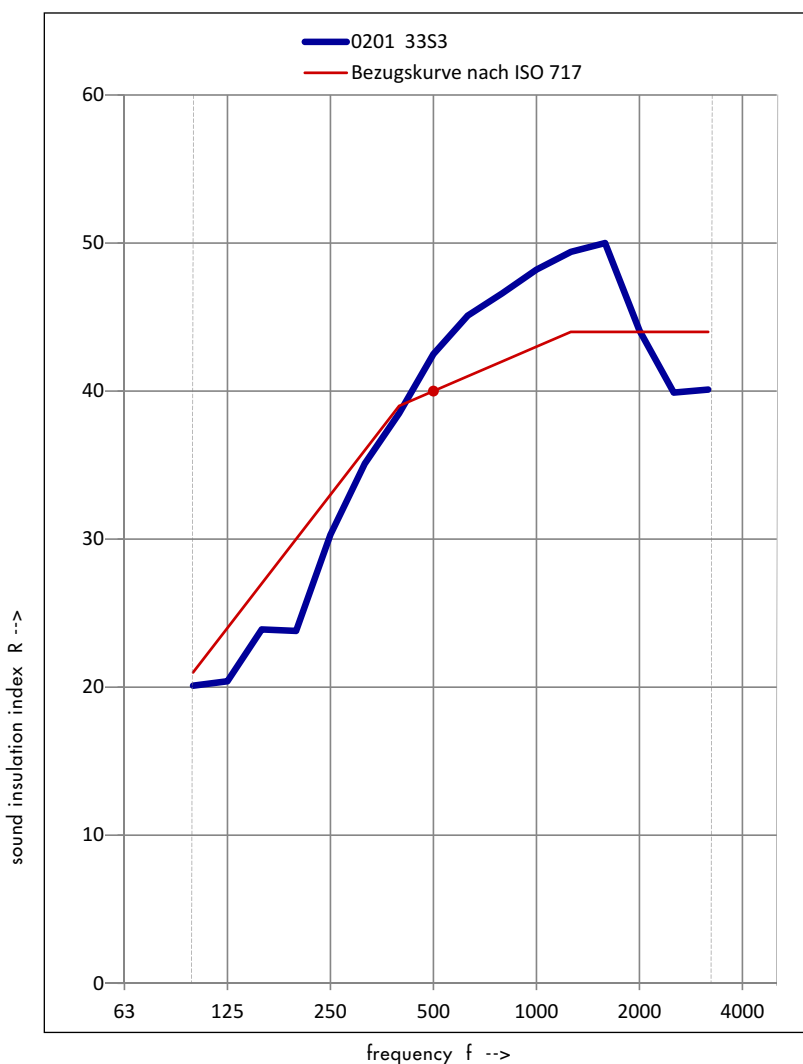

Airborne sound insulation $R_{WV} (C, C_{tr}) = 40 (-2; -6)$ dB
 C50_3150: - C50_5000: - C100_5000: -
 Ctr50_3150: - Ctr50_5000: - Ctr100_5000: -

Sauerland-Service-Centre

Order number: 0201-1/95
 Gotha, 13.04.1995